

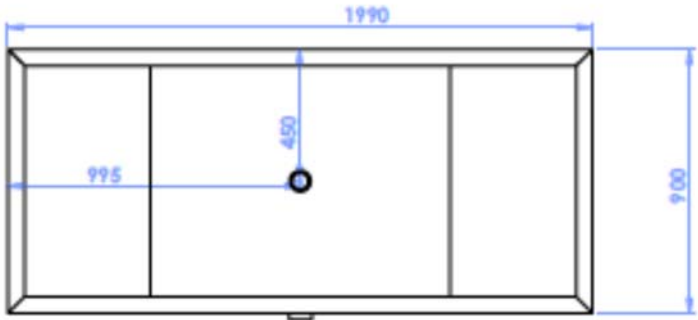

MATIGNON PS IM-WMAT900

SOLID WOOD FREESTANDING BATHTUB

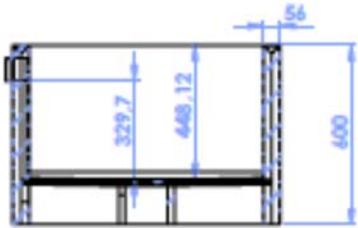
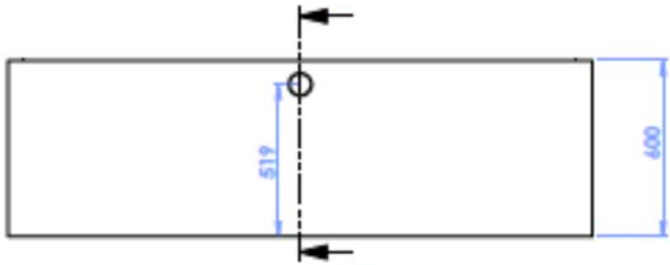

MATIGNON BATHTUB PS IM-WMAT900  
78" x 31" x 24" - 258 LBS  
WATER CONTENT 118 GAL. / 450 LIT.

BUILT IN OVERFLOW LINE.  
POP-UP, DRAIN & P-TRAP INCLUDED.  
AVAILABLE IN OAK / BIRCH / IROKO / WALNUT / WENGE WOOD.  
GLOSSY OR SEMI GLOSS FINISH AVAILABLE

FOR CUSTOM DIMENSIONS, PLEASE CALL OR EMAIL US.



Project Information		
Job Name: _____	Date: _____	Type of hardware: _____
Comments: _____		
Approved: _____		